

PRELIMINARY and FINAL DEVELOPMENT PLAN • SUBDIVISION 7588

CONTRA COSTA COUNTY, CALIFORNIA

VICINITY MAP

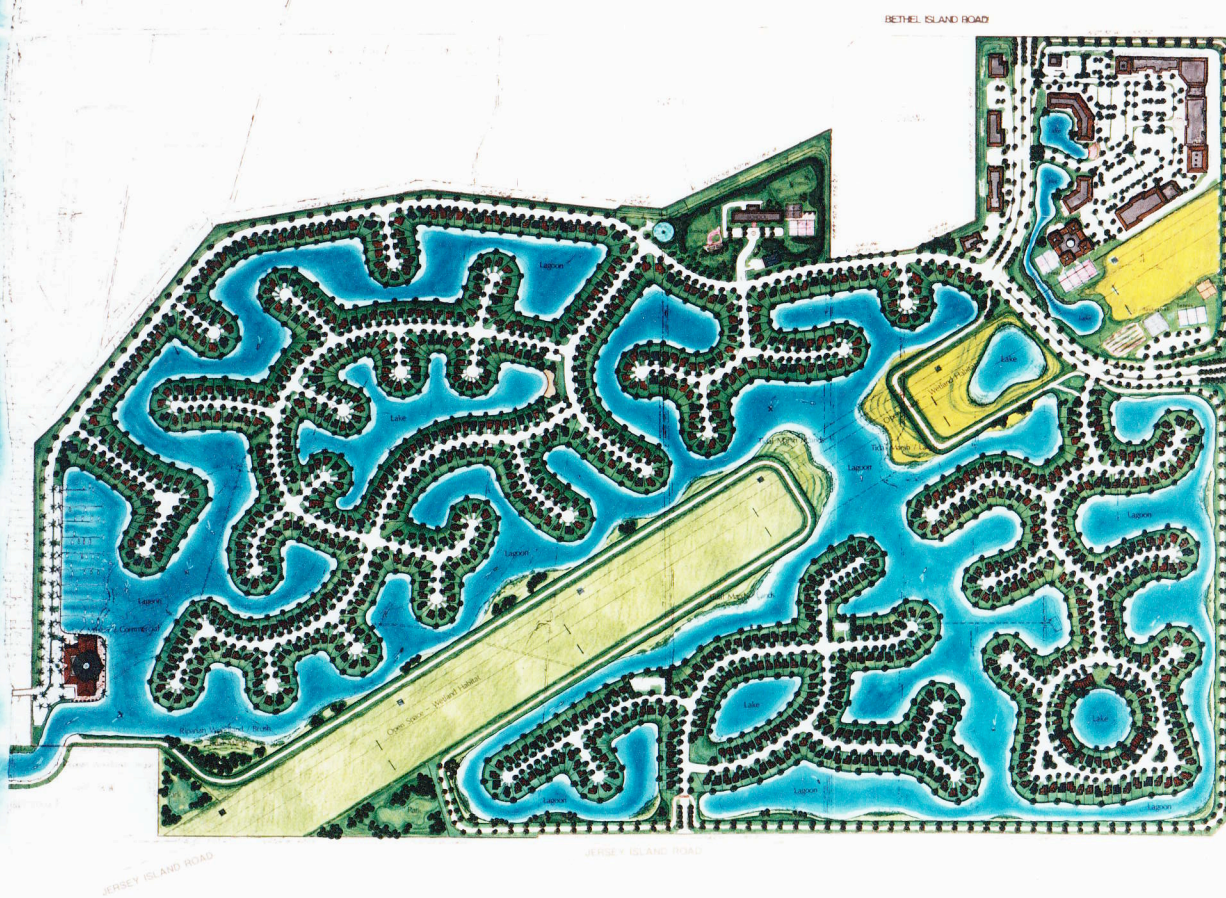

LAND USE :	UNITS :	ACRES :	% :
RESIDENTIAL			
SFR - DEEP WATER LOTS 6000 SQ. FT.	881	175.28	25.00
SFR - LAKE LOTS 5000 SQ. FT.	165	27.28	4.00
MFR - CONDOMINIUM, 12 UNITS/ACRE	32	2.78	1.00
SUBTOTAL	1078	205.35	30.00
BUSINESS			
RETAIL BUSINESS - PCL F		33.02	5.00
MULTIPLE USE - PCL G		18.95	2.90
MARINA COMMERCIAL - PCL J		5.90	1.00
SUBTOTAL		57.87	8.90
OFFICE			
PROFESSIONAL OFFICE - PCL H		8.05	1.20
SUBTOTAL		8.05	1.20
OPEN SPACE			
TIDAL LAGOON - PCL A		215.32	31.40
LAKES - PCLS. B,C,D AND E.		21.26	3.10
EXTERIOR LEVEE - PCLS. I,Q,R,S AND T.		51.98	7.70
PARKS - PCLS. M,N AND O.		9.83	1.40
WETLAND HABITAT - PCLS. K AND L.		59.20	8.80
SUBTOTAL		357.59	51.40
SCHOOL AND DAY CARE CENTER - PCL P.		15.01	2.20
STREET AND HIGHWAY		52.00	7.70
GAS WELL PCLS. - V, Y AND AA		1.93	1.00
SANITARY SEWER PUMP STATION and WATER RESERVOIR		2.20	1.00
TOTALS :	700	100.00	

GENERAL NOTES



LESHER KEYS

BRYAN & MURPHY ASSOCIATES, INC.
CONSULTING ENGINEERS • LAND PLANNERS • SURVEYORS

DATE	DESCRIPTION